

# PREFERRED SCHEME OVERVIEW PLAN

Scale - 1:10000

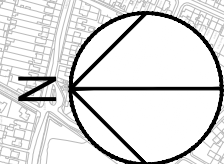

**Key**

- Proposed new construction
- Road to be closed
- Road markings to be modified/removed
- Alternative route

**Note**

1. All alignments shown are indicative only and are subject to variation.

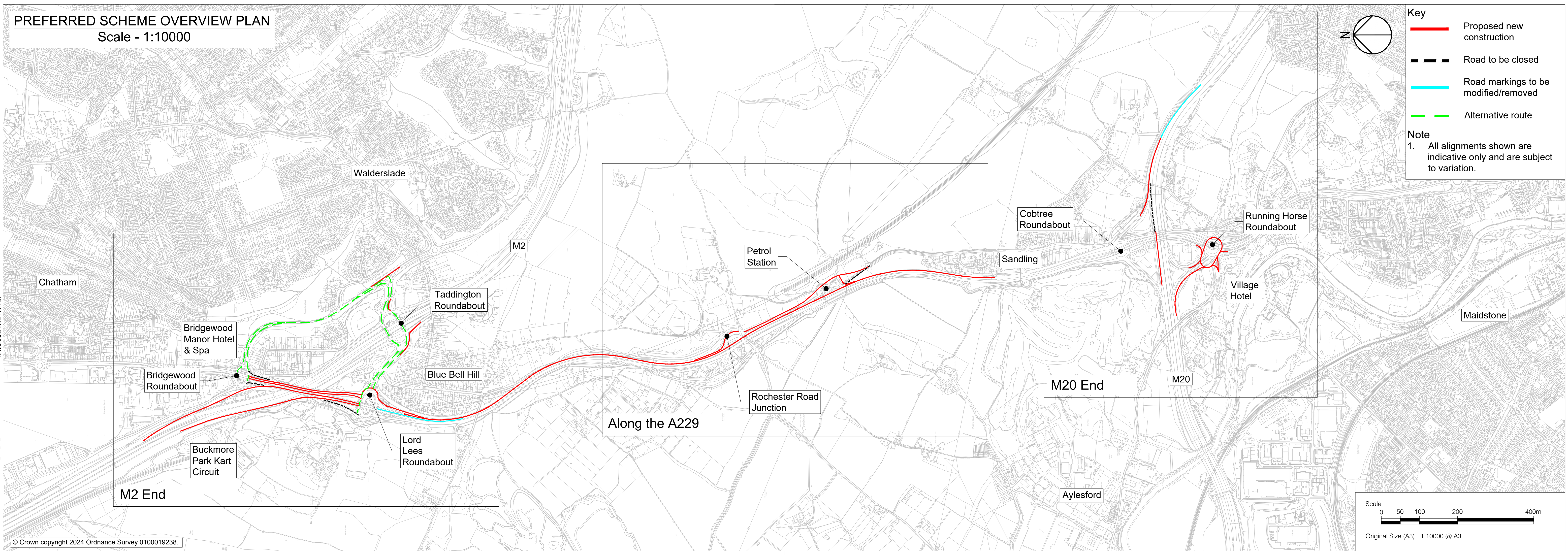

File Name 6063526-ACHM-HML-A229\_SW\_ZZ\_ZZ-DR-CH-0077\_P02 Plot Date -18 December 2024 11:51:53

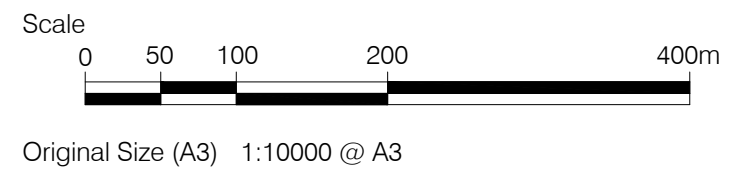



Key

 Proposed new construction

 Road to be closed

Note

- 1. All alignments shown are indicative only and are subject to variation.

# PREFERRED SCHEME PLAN ALONG THE A229 Scale - 1:5000

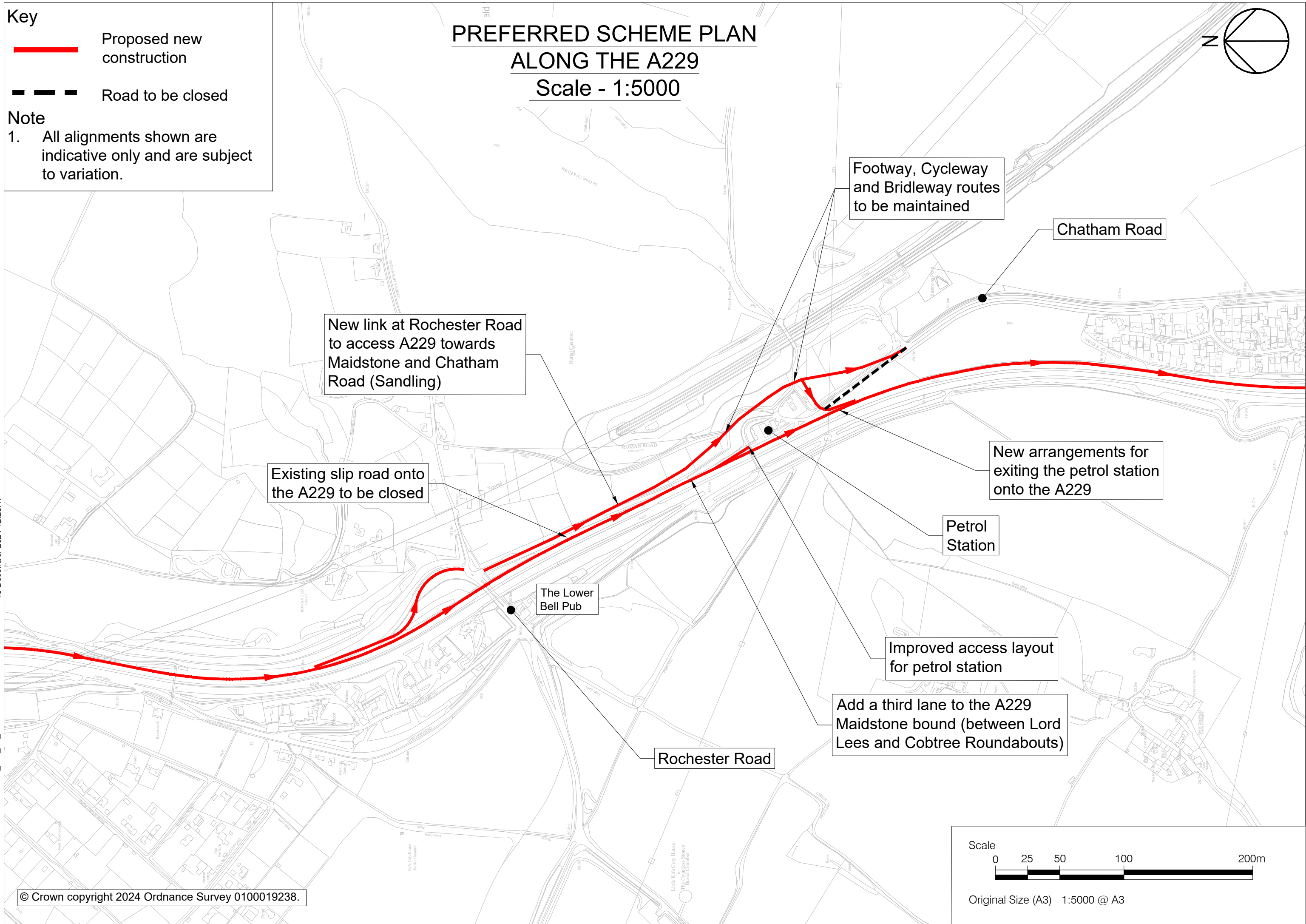
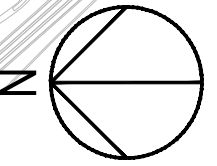

New link at Rochester Road to access A229 towards Maidstone and Chatham Road (Sandling)

Existing slip road onto the A229 to be closed

The Lower Bell Pub

Rochester Road

Footway, Cycleway and Bridleway routes to be maintained

Chatham Road

New arrangements for exiting the petrol station onto the A229

Petrol Station



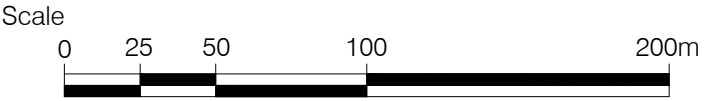

Improved access layout for petrol station

Add a third lane to the A229 Maidstone bound (between Lord Lees and Cobtree Roundabouts)



Original Size (A3) 1:5000 @ A3

**Key**

-  Proposed new construction
-  Road to be closed
-  Road markings to be modified/removed
-  Traffic Signal

**Note**

1. All alignments shown are indicative only and are subject to variation.

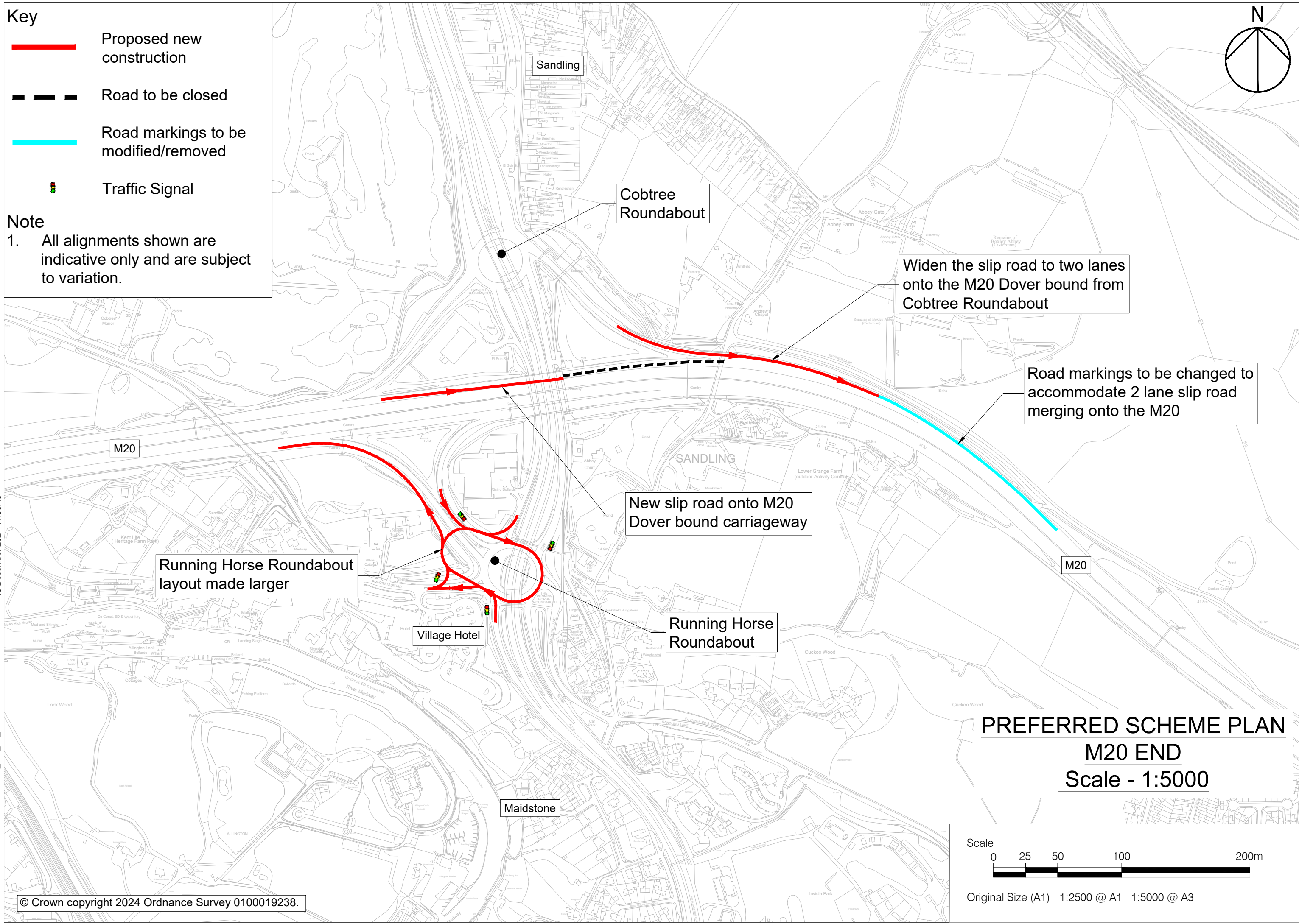
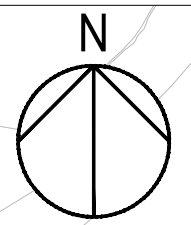

Widen the slip road to two lanes onto the M20 Dover bound from Cobtree Roundabout

Road markings to be changed to accommodate 2 lane slip road merging onto the M20

New slip road onto M20 Dover bound carriageway

Running Horse Roundabout layout made larger

Running Horse Roundabout

Village Hotel

Maidstone

**PREFERRED SCHEME PLAN**  
**M20 END**  
**Scale - 1:5000**



Original Size (A1) 1:2500 @ A1 1:5000 @ A3